

Natural Light[®] BEER

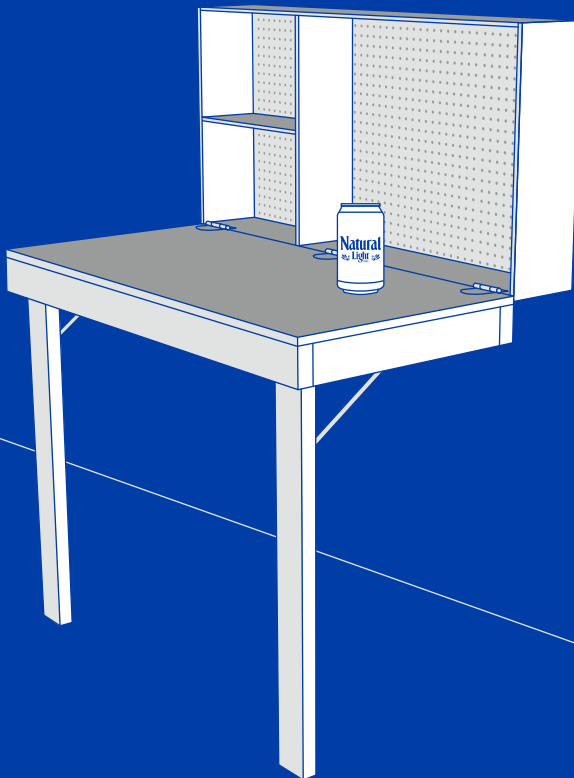

INTRODUCING THE TOOLBAR

A wall-mounted, fold-down workbench that doubles as a post-project relaxation zone. By day, it's your workspace. By night, it's a beer-slingin', dart-hittin' mancave. Ready to get crafty with your beer? Let's get to work.

DIMENSIONS

FOLDED OUT

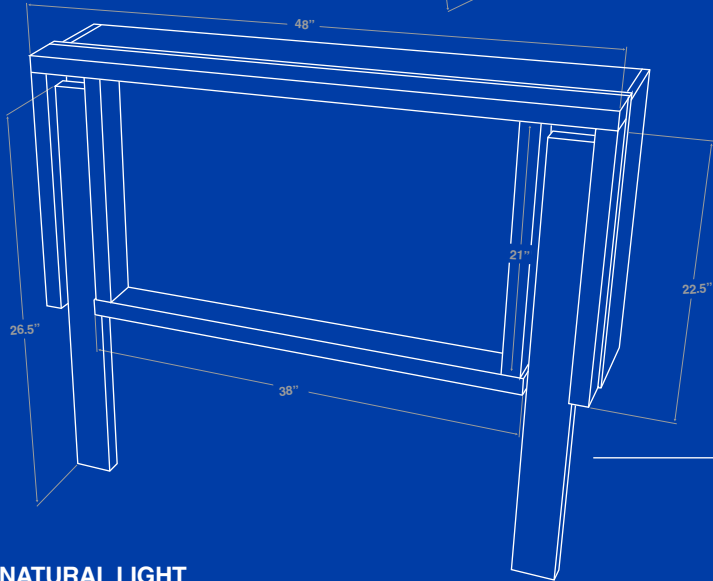
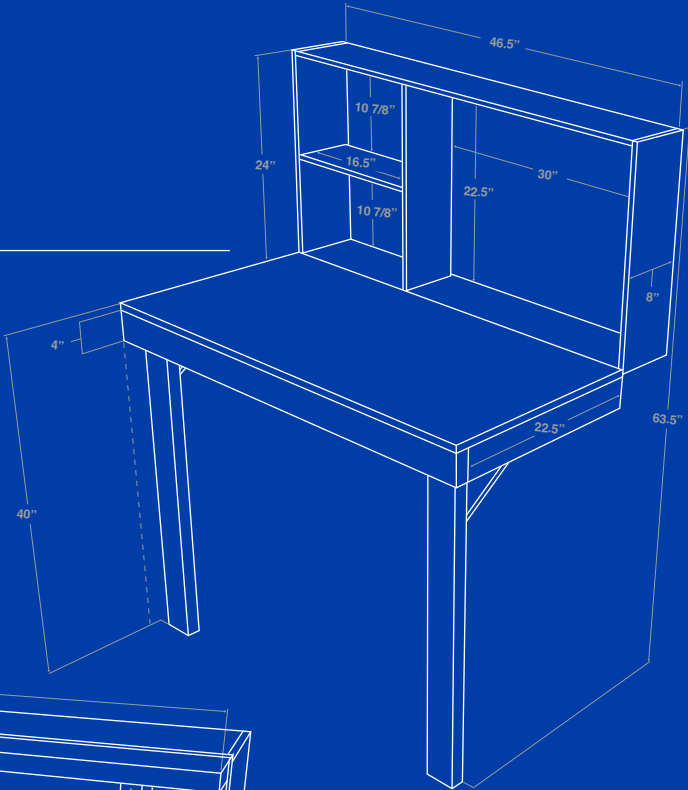

FOLDED UP

NATURAL LIGHT
TOOLBAR
SPECIFICATIONS



SUPPLY LIST (ITEMS NOT TO SCALE)

Natural Light[®]
BEER

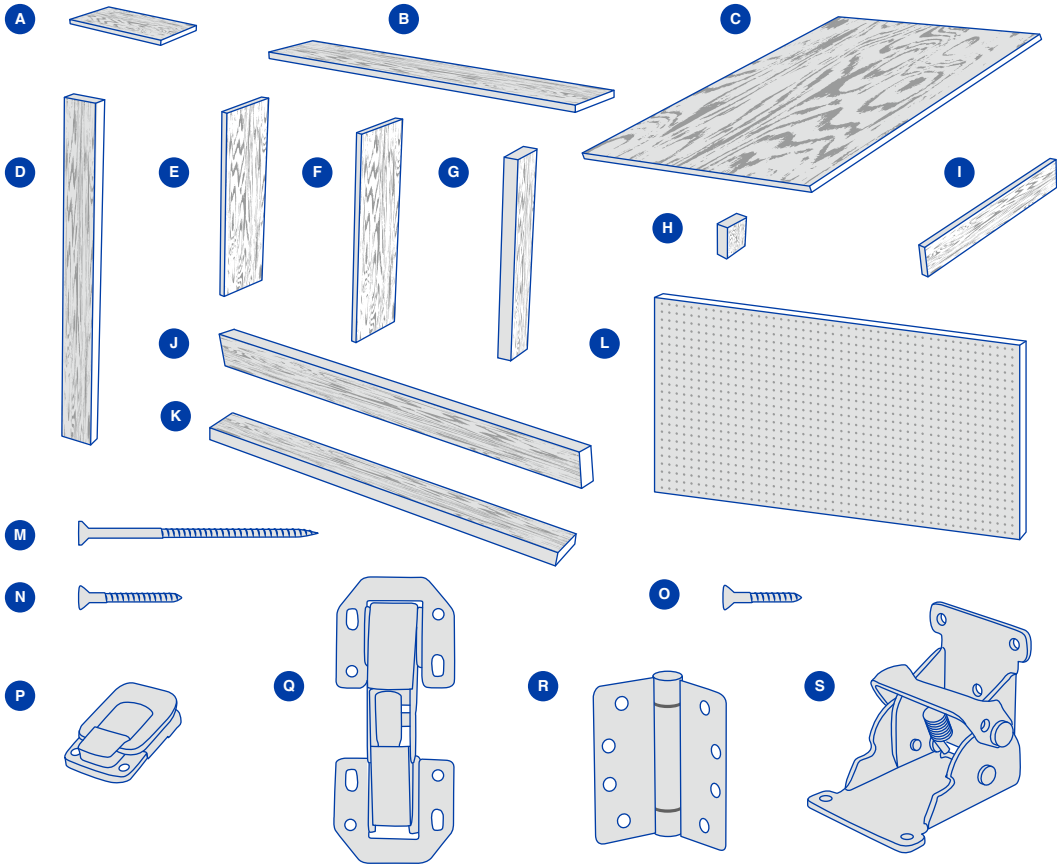

LUMBER & BOARDS

- A 1" x 8"x 16.5"
- B 1" x 8"x 46.5" (x2)
- C PLYWOOD - 24"x48" (x2)
- D 2" x 4"x 26.5" (x2)
- E 1" x 8"x 22.5"
- F 1" x 8"x 24" (x2)
- G 2" x 4"x 21" (x2)
- H 3.5" x 3.5"x 1" (x12)

- I 2" x 4"x 22.5" (x2)
- J 2" x 4"x 48"
- K 2" x 4"x 38"
- L PEGBOARD - 24"x48" (x1))

HINGES & FASTENERS

- M SCREWS - 3.5" (x50)
- N SCREWS - 1.5" (x50)
- O SCREWS - 1" (x25)
- P BRIEFCASE LATCH (x2)

- Q CABINET HINGE - 90° (x2)
- R BASIC HINGE - 4"x1/4" (x3)
- S SELF-LOCK HINGES - Max. 3" Wide (x2)

NOT PICTURED

- PEGBOARD HOOK (x1)
- PEGBOARD BASKETS (x3)
- DART HOLDER (x1)
- CAN HOLDERS (x2)

STEP ONE

BUILD WALL SHELF

Natural Light[®]
BEER

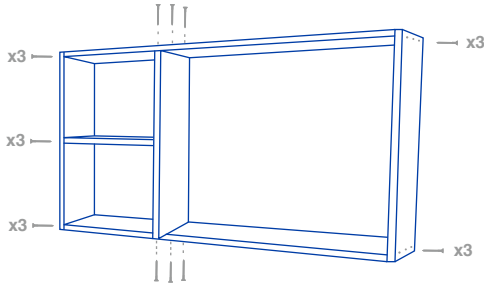

- 01** Using the **1" x 8" lumber**, build the **perimeter** and **dividers** of the **wall shelf frame**.

NOTES

Pre-drill all holes to avoid splitting the wood. Use **1.5" screws**. Three per attachment point should do the trick.

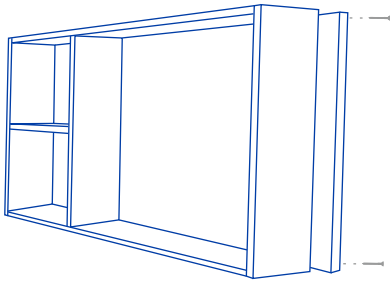

- 02** Once assembled, mount the **wall shelf frame** to a piece of **plywood** using **1.5" screws**.

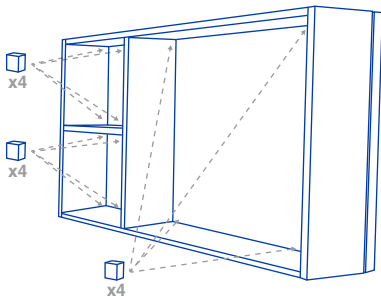

- 03** Install a **pegboard mounting block** in all four (4) corners of each tool storage section, including the perimeter and both dividers.

NOTES

You should end up with **12 blocks total**. Secure each with **1.5" screws**.

BUILD WORKBENCH

- 04** Using the **designated 2" x 4"s**, assemble the **perimeter** and **support** sections of your **workbench frame**.

NOTES

Use **3.5" screws** — two per attachment point should do the trick. Just be sure to avoid screwing too close to the edges of the boards to prevent splitting.

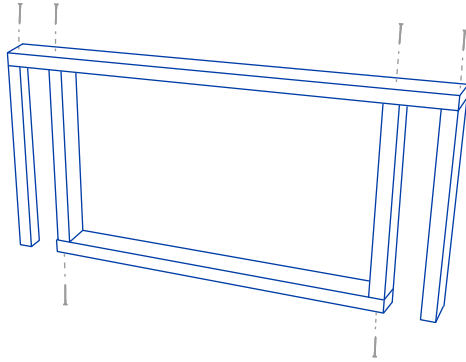

- 05** Once the frame is assembled, mount it to a piece of plywood to create your work surface.

NOTES

Use **1.5" screws**, drilling down through the top of the **plywood**. Place screws about $\frac{3}{4}$ " in from the outer edge, aiming for the center of the 2" x 4" boards beneath. You'll need about **2–4 screws per board**, depending on the length.

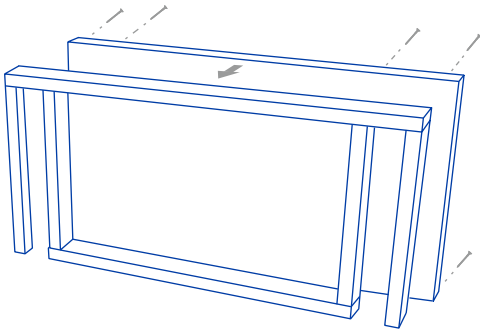

IMPORTANT: Don't install the front legs yet. You'll do that after the unit is mounted to the wall.

INSTALL HINGES & LATCH

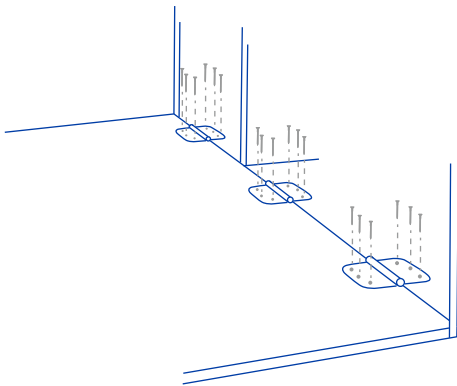

- 06** Place the **workbench** and **wall shelf** on the floor. Connect the sections using the **4" workbench hinges** with the short edges aligned.

NOTES

Align the face of the **wall shelf** with the face of the **workbench**. Using **1.5" screws**, install three (3) hinges on the bottom edge.

- 07** Install the **briefcase latch** on either the side or top of the unit (builder's choice), using **1.5" screws**. This will hold your ToolBar closed when folded.

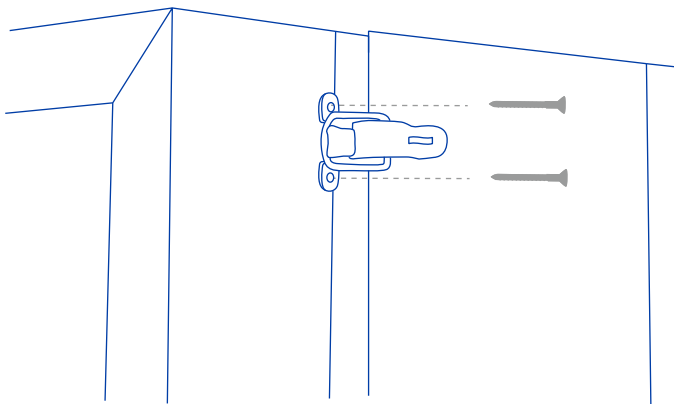

STEP FOUR

MOUNT UNIT TO WALL

Natural Light[®]
BEER

- 08** Assess your wall, decide where you want your work of art to live, and draw a horizontal level line 39.5" above the floor.

- 09** Locate and mark two studs (not counting yourself, though clearly, you are one).

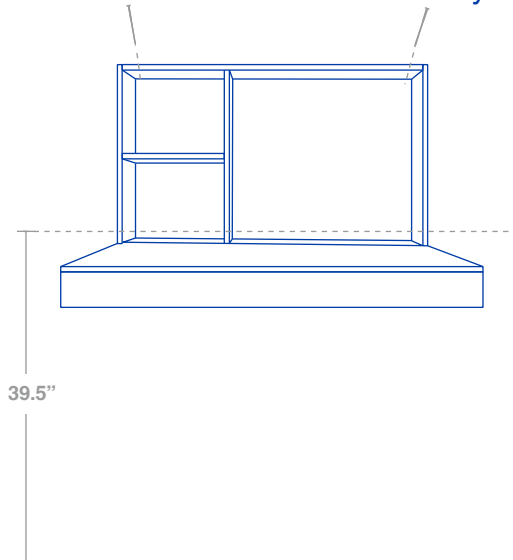

- 10** Grab another stud (aka a friend) to help you lift the ToolBar into place.

- 11** Secure the wall shelf section to the wall using **3.5" screws** driven into the studs.

- 12** Ensure the unit is level and tightly anchored. This thing's gotta support tools and tallboys.

PRO TIP

Use a ledger board to safely open, level, & screw the ToolBar to the wall.

STEP FIVE

INSTALL FOLDING LEGS & STABILIZERS

Natural Light[®]
BEER

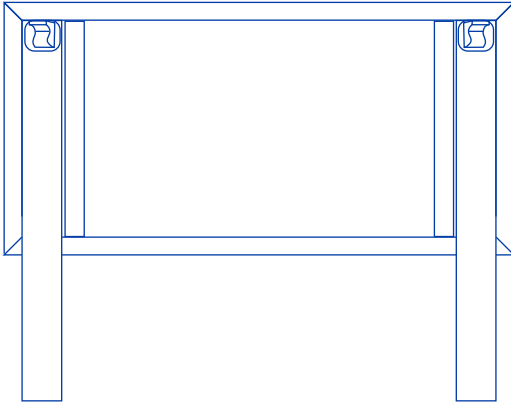

- 13** Attach self-locking hinges to the inside corners of the workbench frame.

- 14** Cut and mount two front legs using **2" x 4"s**.

- 15** Attach **cabinet-style stabilizers** to lock the legs into place when extended.

- 16** Test the fold-down motion to make sure it's smooth and secure.

NOTES

If it feels clunky, double-check your hinges. Adjust leg length as needed. Garage walls and floors may vary in how level the legs are.

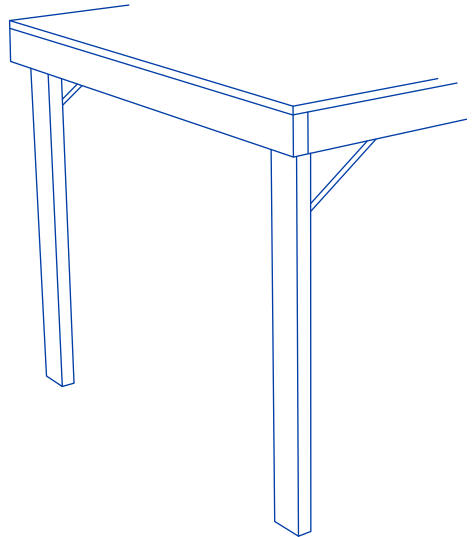

INSTALL DARTBOARD & ATTACHMENTS

- 17** Fold the **ToolBar** into its closed (upright) position.
- 18** Mount the **dartboard** at the center of the outer surface using **1" screws**.

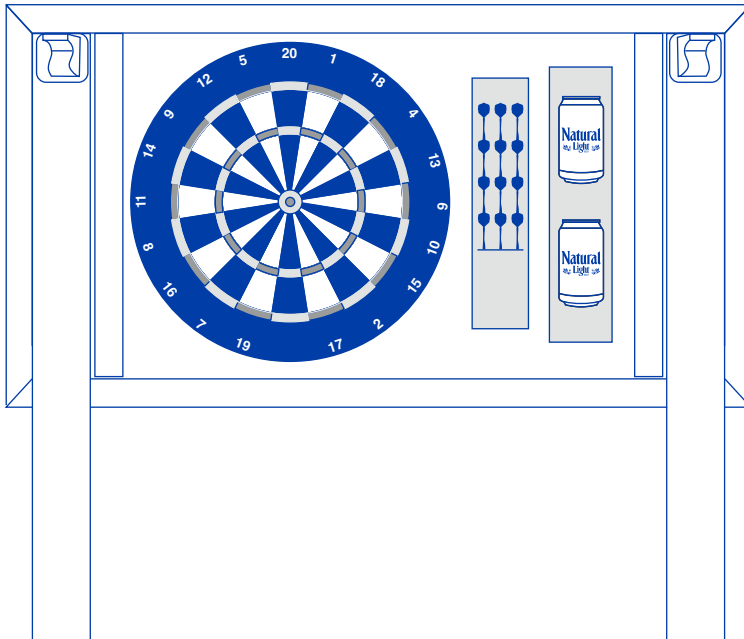

- 19** Add the **dart holder** and **can holders** wherever feels right. Move ‘em around a few times, or don’t. That’s your call.

NOTES

The dartboard should be screwed in at both the top and bottom so it doesn’t fall off when it is lowered to workbench mode.

STEP SEVEN

INSTALL PEGBOARD & TOOL HOOKS

Natural Light[®]
BEER

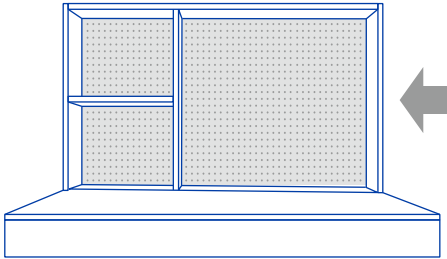

20 Insert the **pegboard panels** into the **framed sections** of the **wall shelf**.

21 Secure each panel to the **mounting blocks** using **1.5" screws**.

22 Add **hooks, baskets,** and **other accessories** to organize your gear.

23 Customize to your heart's content. Brag to your friends. And most importantly, crack open an ice-cold Natty. You've earned it.

