

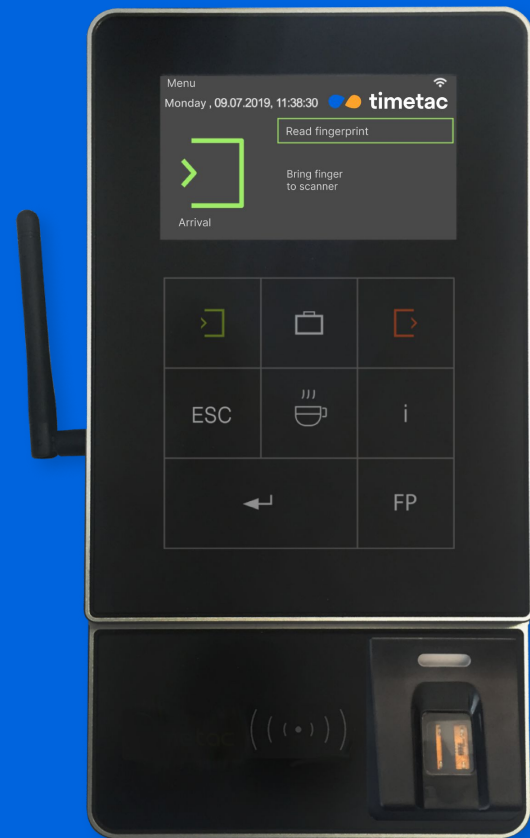

Options, Configurations and Pricing

Evo Advanced Time Clock



Information
next.timetac.com



TimeTac Evo Advanced Time Clock

Upgrade your time tracking with the TimeTac Evo Advanced Time Clock. With fingerprint or RFID/NFC keyring options, employees can easily record their arrival, departure, and break times. This convenient system stores all data in one place, allowing easy access and analysis from any device. It is ideal for environments without computers or smartphones, such as factories and hospitals. Opt for efficiency and accuracy in time management with TimeTac.

- ① 266×144×95mm casing
- ② Colour-LCD 272×480 px display with touch screen
- ③ Glass front with LED-Backlight
- ④ Simple keyboard layout for arrival, absences and departure
- ⑤ High quality anodized aluminium frame
- ✓ RFID or RFID + fingerprint reader
- ✓ LAN, WLAN or GPRS (mobile) connectivity
- ✓ IP54 protection

Configurations and Pricing

The Evo Advanced Time Clock offers you different configurations to choose from. All of these time clocks include a TCP/IP LAN network card, wall mounting fixtures and a power cable. When ordering time clocks, please consider that configurations must be conducted by our hardware supplier and cannot be performed on-site.

Terminal Evo Advanced with RFID/NFC-Reader**

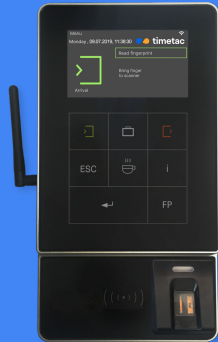

from £ 42.90 monthly*

Further Configurations and Additions

Time Clock Configurations

- + Fingerprint Reader** £ 9.90*
- + POE (Power over Ethernet) Adapter*** £ 2.50*
- + GPRS Module (data plan not included) £ 8.50*
- + WLAN Module - 802.11bg and 802.11n £ 6.90*

Additions

- + RFID/NFC Key Ring (one time, net price per piece) £ 2.90

* Monthly rental fee, with a yearly plan. All stated prices are net.

** 13.56 MHz RFID/NFC Reader (ISO 14443: Mifare-Classic, MifareDesfire, -Plus, Ultralight). Readers for other RFID standards available if required.

*** Supported: IEEE 802.3af und IEEE 802.3at

Technical Details

Casing	Structure	Aluminium front panel with a glass, capacitive touch display and an ABS body
	Dimensions (height x width x depth)	266 × 140 × 95 mm
	Weight (w/o power supply)	Base unit 0.98kg plus wall mount plate of 0.235 kg
Display	LCD	TFT: 272 × 480 pixels, active area 95 × 53.9 mm with LED backlight incl. proximity sensor for automatic activation in sleep mode
Power Supply	Power	12 V DC
Environment values	Ambient temperature	-20°C to + 60°C
	Protection	IP54 complete, IP65 front
Data transmission	TCP / IP (optional)	TCP / IP operating with integrated TCP / IP stack, 10/100 Mbit
	WLAN (optional)	Integrated wireless LAN module, WIFI 802.11 b/g and 802.11n (Only 2.4 GHz)
	GSM / GPRS (optional)	GSM/GPRS, mobile module quad band 850 / 900 / 1800 / 1900 MHz
	USB	Micro-USB for setup of data transmission
	Details	<ul style="list-style-type: none"> • via HTTPS, DHCP as per default • DNS per default 8.8.8.8, individual settings possible • The ports 443 and 8000 have to be released. Port 443 for data transmission to gt.timetac.com and port 8000 for maintenance connection on dfa.timetac.com
Additional Options	Fingerprint (optional)	Fingerprint module optional; sensor in lower right of housing
	Transponder reader	125KHz - Unique, titanium, Hitag. 13,56 MHz - Legic, Mifare, ISO14443, ISO15693, SimonsVoss, iButton, Nedap

next.timetac.com

info@timetac.com



**because
time
matters**

DE/AT: 0800 - 240 40 50

Int. +43 (0)316 587142

ES: +34 900 751400